

Cordless Cellular Shade Installation Instruction

IDENTIFY YOUR CELLULAR SHADE AND PARTS

Your parts may vary, depending on the custom request, size of the shade, and size of the headrail you are purchasing.

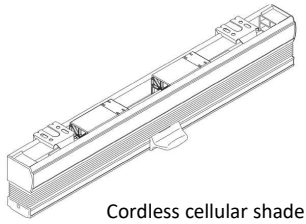

Cordless cellular shade

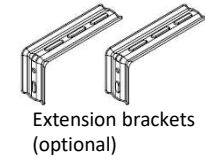
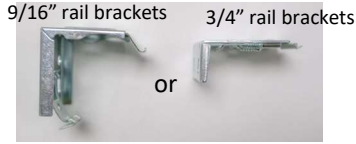

Extension brackets (optional)

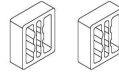

Spacers (optional)



screws



Bottom rail handle

Shade width	Qty of brackets	Qty of handles
W ≤ 36"	2	1
36" < W ≤ 48"	3	1
48" < W ≤ 72"	3	2
72" < W ≤ 96"	4	2
96" < W ≤ 120"	5	2

* 2-on-1 shade will double the quantity of handles.

* 3-on-1 shade will triple the quantity of handles.

TOOLS AND PARTS YOU MAY NEED (not included)

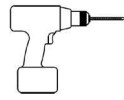

Drill with bits

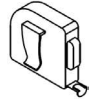

Metal tape measure



Pen



#4 x 3/4" flat head wood screw



Screwdriver

FOR THE 3/4" RAIL BRACKETS

1. Install the brackets

- Mark the bracket locations, separating the brackets evenly. Make sure all brackets are aligned and level with each other.
- For inside mount - Install the bracket with the hole at top center by using the included screw or with two holes at the top rear side by using #4 x 3/4" flat head wood screws (not included).
- For outside mount - install the bracket with two holes at the back side with included screws.

- Fasten the screws completely.
- Install the shade with the extension brackets (optional)
 - Install the extension bracket with at least 2 screws.
 - Attach the mounting brackets to the extension brackets with the screws.

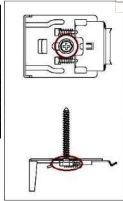
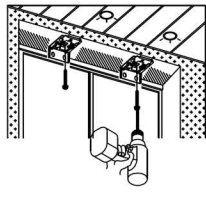

Inside Mount

Use #4 x 3/4" flat head wood screws (not included) for these two holes

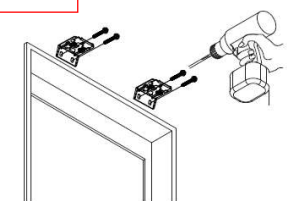
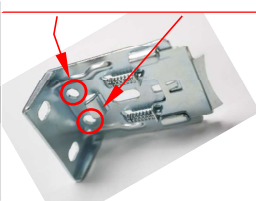

Outside Mount

Extension bracket

Optional - Add a spacer behind the bracket if needed.

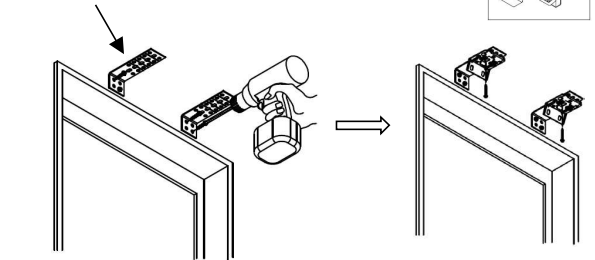

2. Attach the cell shade

- Position the headrail with the front lip resting on the top hooks of all the brackets.
- Push the bottom of headrail firmly upward and toward the window until the groove at the bottom of the headrail snaps into place.

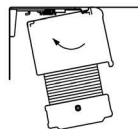
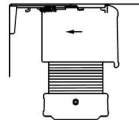

Mounting spaces

- Minimum mounting space - 1/2"
- Flush mounting space
 - 2-1/4" for 9/16" and 7/16" fabrics
 - 2-1/2" for 3/4" fabrics
 - 2-7/8" for 1-1/4" fabrics

3. How to remove the shade from the brackets

- Raise the shade completely. Push the headrail toward to the wall.
- Tilt the backside of the headrail down
- Once the back of the headrail clears the brackets, pull the headrail off the front of brackets.

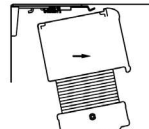
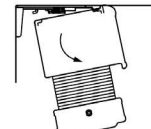
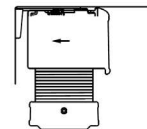

Cordless Cellular Shade Installation Instruction

FOR 9/16" RAIL BRACKETS

1. Install the brackets

- Mark the bracket locations, separating the brackets evenly. Make sure all brackets are aligned and level with each other.
- For inside mount - Install the bracket with the holes at top by using the included screws.
- For outside mount – install the bracket with the holes at the back side with included screws.

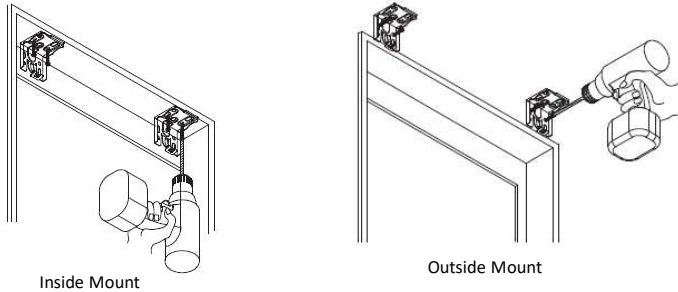

- Fasten the screws completely.
- Install the shade with the extension brackets (optional)
 - Install the extension bracket with at least 2 screws.
 - Attach the mounting brackets to the extension brackets with the screws.

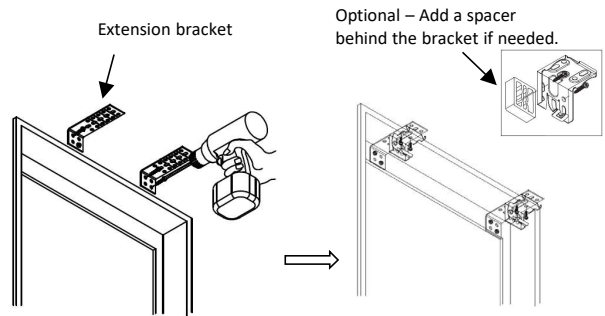

2. Attach the cell shade

- Position the headrail with the front lip resting on the top hooks of all the brackets.
- Push the bottom of headrail firmly upward and toward the window until the groove at the bottom of the headrail snaps into place.

Mounting spaces

- Minimum mounting space – 7/8"
- Flush mounting space
 - 2" for 9/16" and 7/16" fabrics
 - 2-1/8" for 3/4" fabrics
 - 2-1/2" for 1-1/4" fabrics

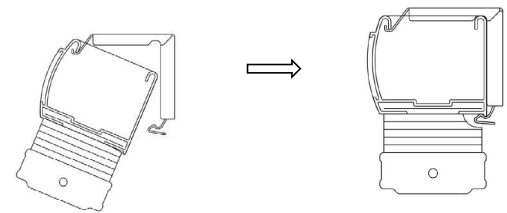

3. How to remove the shade from the brackets

- Raise the shade completely.
- Use a flat screw to push the bracket tab toward to the wall. Once you hear a "click", then the shade will be released from the bracket.
- Repeat above step to release the shade from other brackets.

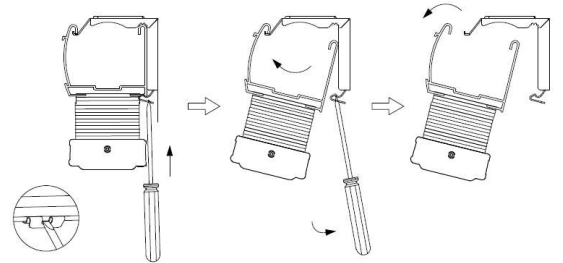

INSTALL THE HOLD DOWN BRACKETS (optional)

- A hold down bracket secures a shade's bottom rail to the bottom of a door or window to prevent it from moving. These are usually only needed when installing shades on doors and in RVs to help to prevent damage to your blinds, doors, and windows.
- The hold down bracket shall be installed to the wall when it is an outside mount or to the jamb of the window frame when it is an inside mount. Do not install hold down brackets on the sill of the window frame.
- Fully lower the shade and insert the hold down bracket pin into the hole at the side of the bottom rail end-cap, one hold down bracket per each end cap, then mark the location of each hold down bracket.
- Each hold down bracket should be secured with two screws.
- Place the hold down bracket pins into the end caps of the bottom rail to secure the bottom rail in place.

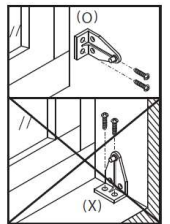

Hold down bracket (optional)

ATTACH THE PULLING HANDLE AND OPERATE THE SHADE

- Attach the pulling handle at the center of the bottom rail when you have one handle.
- Attach pulling handles evenly to the bottom rail when you have 2 handles.
- Pull the bottom rail down to lower the cellular shade or push the bottom rail up to raise the cellular shade.

NOTE. Please allow 24 hours for your shade to drop to its actual height when first installed due to the nature of the fabric.

CARE AND CLEAN

- To clean surface-level dust and dirt, lift it away by gently sweeping it across the fabric with a duster or vacuum it gently with the soft brush attachment.
- If any debris is trapped inside the fabric cells, blow it out with compressed air or with a hairdryer on a slow speed and cold mode.
- To clean away stains, you can try to blot the stain with a lint-free damp cloth (almost completely dry) and mild detergent if needed. Avoid scrubbing the fabric, as it may cause the fabric to pill. Using another cloth, blot the fabric dry to prevent water rings.
- Be sure not to submerge your cellular shades/ fabrics in water or over wet them, as they may fade and damage the shade.